

Am. Red Cross
A.P.O. 442
Cm. 2. Form, 2/45

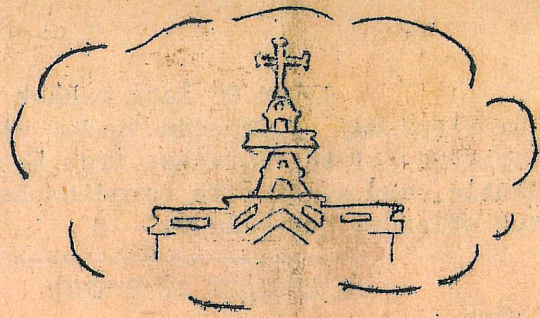

THE
LIBERATION BULLETIN OF
PHILIPPINE INTERNMENT CAMP NO: I. AT
SANTO TOMAS UNIVERSITY
MANILA, PHILIPPINES.

FEBRUARY 3rd, 1945 —

copyright 1945
Peter C. Richards
all rights reserved

WITH THE FORCES
ITS
Chesterfield

They satisfy

SAN MIGUEL BREWERY

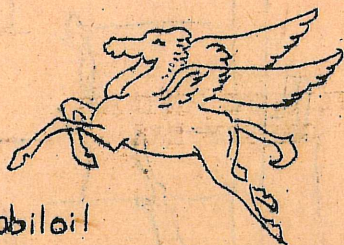

Mobiloil

Mobilgas

STANDARD VACUUM OIL CO.

And so to Freedom with

ASIA LIFE INSURANCE COMPANY

P. R. Danner,
Philippine Manager.

Steel for every purpose
everywhere



UNITED STATES STEEL
EXPORT CO.

After 37 long months we celebrate our first day of freedom to-day with the final departure of the Japanese from the City of Manila, and await with bounding hearts our own, our friends, our allies.

CHRONOLOGY OF EVENTS

1942

- Jan. 4. 1st. group arrives at Santo Tomas for internment.
- 17. Holy Ghost Home for Children starts.
- 31. Central Kitchen opens.
- Feb. 15. Three men shot for escaping.
- 21. 113 China refugees arrive from Sulphur Springs.
- Mar. 8. 12 Navy Nurses arrive.
- Apr. 8. The Earthquake.
- 15. Last Wheat bread.
- June 17. 43 Consular repatriates depart.
- July 1. Japanese take over from Philippine Red Cross the financing of the Camp at 40 centavos per person per day.
- 2. 72 Army Nurses arrive.
- 27. 2nd. Executive Committee take over.
- Aug. 24. Santa Catalina Hospital starts.
- Sep. 12. 113 Internees leave for Shanghai.
- Oct. 31. 11 of High Commissioner's staff arrive.
- Dec. 17. South African Relief Supplies arrive.
- 19. Cebu Internees arrive.
- 23. 1st. Movie.

1943

- Jan. 6. Canadian Relief Supplies arrive.
- 12. 28 men taken out to Military Camps.
- 16. Tacloban Internees arrive.
- Mar. 10. Bacolod Internees arrive.
- May. 14. 1st. Los Baños Transfer.
- 17. Re-internment of aged, sick and children previously living outside Camp.
- June 21. Ilcilo internees arrive.
- Sep. 26. 124 Repatriates depart.
- Nov. 15. The Flood.
- Dec. 10. 2nd. Los Baños Transfer, including 1st. group of women.
- 15. American Relief Supplies arrive.

1944

- Jan. 2. Davao Internees arrive.
- Feb. 1. Military Administration takes over Camp. Filipino Doctors and Nurses, also market vendors barred. Daily cereal ration 400 grams per person per day.
- 7. Package Line closed.
- 10. Holy Ghost Children's Home Closed.
- 18. 2nd. Executive Committee abolished and 3-man Internee Committee appointed by Japanese.

- 1944
- Feb. 20. Military take over Bodega and all food supplies therein.
 - 21. Sulphur Springs Camp closed. American mail arrives.
 - 22. Local newspaper prohibited.
 - Mar. 1. Three U. S. Army Doctors arrive.
 - Apr. 7. 3rd. Los Baños Transfer.
 - May. 12. Last Ricebread.
 - June 6. Central Kitchen starts cooking in outside kitchen permanently with wood.
 - July 1. Last Stage Show.
 - 7. Religious group brought in to Gymnasium incommunicado for transfer to Los Baños. Similar groups from all over the Islands follow during the month.
 - 20. Internees photographed in groups of 5, with numbers on their chests.
 - Aug. 1. All money, except 50 Jap. pesos, to be turned in for deposit with Bank of Taiwan.
 - 30. Remedios Hospital Convalescent Home closed.
 - Sep. 1. Old Men's Home at Hospicio de San José closed.
 - 13. Daily cereal ration 300 gms. per capita.
 - 15. Daily cereal ration 250 gms. per capita.
 - 20. Daily cereal ration 300 gms. per capita.
 - 21. THE AIR RAID.
 - 23. Produce for Vegetable Market so reduced that market at last closes.
 - Oct. 9. Whole front campus taken over by the Japanese Military for storage of their supplies including arms and ammunition.
 - 14. Chairman of Internee Agents banished to Los Baños.
 - Nov. 17. Net daily cereal 255 gms. per capita.
 - Dec. 5. Last Los Baños Transfer.
 - 12. Net daily cereal ration 210 gms. per cap.
 - 20. Net daily cereal 187 gms. per capita.
 - 23. Chairman of Internee Committee and 3 others arrested and subsequently taken out of Camp by Military Police. **BEHEADED BY JAPS**
 - 25. 3785 happy Internees saw, read, recited or heard verbatim reports of the
LEAFLET:- **DROPPED FROM PLANES**
"The Commander in Chief, the Officers and the men of the American Forces of Liberation in the Pacific wish their gallant allies, the People of the Philippines, all the blessings of Christmas and the realisation of their fervent hopes for the New Year
Christmas 1944"
 - Dec. 26. Complete Census of the three camps, Manila, Los Baños, Baguio, ordered to be assembled, copied and delivered in 48 hours.

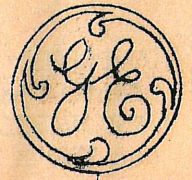

GENERAL ELECTRIC
COMPANY (P. I.) INC.

THE INTERNATIONAL
HARVESTER COMPANY
OF PHILIPPINES.

PHILIPPINE REFINING
COMPANY INC.

GOODRICH
INTERNATIONAL
RUBBER COMPANY

PEACE - - FREEDOM

Speed - Accuracy
Economy
with BULROUGHS
Quality Equipment
and dependable
Worldwide Service

"LEST YOU FORGET"

Santo Tomas
MEMORABILIA
and WHO'S WHO

Complete Story
Roster, Sketches
A book to keep.

Leave your address
with FRED. STEVENS
Box 1447 -- Manila

SAFE

PENNZOIL
LUBRICATION

H.G. LYMAN

REP

"MIZPAH"

WESTERN EQUIPMENT
& SUPPLY CO.
(WEANDSCO)
Bill Chittick

Electrical Supplies
--Installations--

That Final Step to
Security & Contentment
YOUR ANNUITY
with the
MANUFACTURERS' LIFE

Ask NED HALL, Manager,
NOW for latest details

PHILIPPINE
MANUFACTURING
COMPANY.

Purico.
Star Margarine.

1945

- Jan. 6. Japanese staff, ordered to leave, spend all night packing and burning papers.
- 7. Committee members held as hostages all day pending planned departure of the Commandant's staff.
- 9. Commandant issues statement that owing to change of plan he and his staff are not leaving. He expresses concern over food situation.
- 10. Leaflet:- "...The Battle of the Philippines is in it's final phase..."
- 11. We all saw the Stars on their wings!
- 14. War Prisoners' Bureau moves from Far Eastern University into Ed. Building.
- 17. One man escapes from Gya.
- 31. Chairman of Camp Medical Staff jailed by Japanese for refusal to exclude the words "malnutrition" and "starvation" from Death Certificates.

Average daily per capita calories issued by Japanese Army to Camp:- 723.7 during January.

Feb. 3rd. 10 U. S. Planes parade to Santo Tomas, drop goggles and message of good tidings into East Patio.

About 6.00 P.M. continuous machine-gun fire can be heard to the North. Fires break out all around, especially to the North.

9.00 P.M. THE TANK ARRIVES.

Feb. 4th. Third Anniversary of the Inauguration of Santo Tomas Internment Camp... plus one month!... 37 long months.

The Camp Industries on the 4th. Floor of the Main Building produced for general sanitation purposes the following articles:-

Coconut Oil	1,589.2 kilos
Caustic Soda	1,385.7 kilos
Soap	7,632.0 kilos
Calcium Hypochlorite	2,253.0 kilos
Alcohol	82.45 litres

Deaths up to January 31st. 1944 (25 mo.) 185

From Feb. 1st. 1944 to Sept. 30th (8 mo.) 54

from Oct. 1st. to Dec. 31st. (3 mo.) 43

in January 1945 (one month) 32

THE DUNLOP RUBBER COMPANY LTD.

ELIZALDE & CIA.
Philippines Agents

- 1944
- Feb. 20. Military take over Bodega and all food supplies therein.
21. Sulphur Springs Camp closed. American mail arrives.
22. Local newspaper prohibited.
- Mar. 1. Three U. S. Army Doctors arrive.
- Apr. 7. 3rd. Los Baños Transfer.
- May. 12. Last Ricebread.
- June 6. Central Kitchen starts cooking in outside kitchen permanently with wood.
- July 1. Last Stage Show.
7. Religious group brought in to Gymnasium incommunicado for transfer to Los Baños. Similar groups from all over the Islands follow during the month.
20. Internees photographed in groups of 5, with numbers on their chests.
- Aug. 1. All money, except 50 Jap. pesos, to be turned in for deposit with Bank of Taiwan.
30. Remedios Hospital Convalescent Home closed.
- Sep. 1. Old Men's Home at Hospicio de San José closed.
13. Daily cereal ration 300 gms. per capita.
15. Daily cereal ration 250 gms. per capita.
20. Daily cereal ration 300 gms. per capita.
21. THE AIR RAID.
23. Produce for Vegetable Market so reduced that market at last closes.
- Oct. 9. Whole front campus taken over by the Japanese Military for storage of their supplies including arms and ammunition.
14. Chairman of Internee Agents banished to Los Baños.
- Nov. 17. Net daily cereal 255 gms. per capita.
- Dec. 5. Last Los Baños Transfer.
12. Net daily cereal ration 210 gms. per cap.
20. Net daily cereal 187 gms. per capita.
25. Chairman of Internee Committee and 3 others arrested and subsequently taken out of Camp by Military Police. BEHEADED BY JAPS
25. 3785 happy Internees saw, read, recited or heard verbatim reports of the LEAFLET:- DROPPED FROM PLAINES
- "The Commander in Chief, the Officers and the men of the American Forces of Liberation in the Pacific wish their gallant allies, the People of the Philippines, all the blessings of Christmas and the realisation of their fervent hopes for the New Year
- Christmas 1944"
- Dec. 26. Complete Census of the three camps, Manila, Los Baños, Baguio, ordered to be assembled, copied and delivered in 48 hours.



GENERAL ELECTRIC
COMPANY (P. I.) INC.

THE INTERNATIONAL
HARVESTER COMPANY
OF PHILIPPINES.

PHILIPPINE REFINING
COMPANY INC.

GOODRICH
INTERNATIONAL
RUBBER COMPANY

PEACE - - FREEDOM

Speed - Accuracy
Economy
with BULROUGHS
Quality Equipment
and dependable
Worldwide Service

The Daily average per capita value of the Food, supplied since February 1944 by the Japanese Army to the Santo Tomas Camp, compared with recognised Standard Requirements:-

	Protein Grams	Carbo- hydrate Grams	Fat Gms	Calories
Required by avg. man, light labor	70	455-510	75-100	3,000-3,500
Required lying quietly in bed.	at the rate of			2,400
Supplied by Jap. Army to Internees (All labor in Camp)				
1944 February	36.6	295	13.8	1,452
March	39	349	11.7	1,660
April	35	289	9.8	1,380
May	38.7	306	13.8	1,503
June	39	355	17.8	1,736
July	26.6	257	19.8	1,321
August	29	285	11.5	1,360
September	27.8	252	12.6	1,229
October	24	203	12.4	1020
November	25.5	194	13.4	999
December	19.6	185	9	698
Average 1944	31.2	270	13.2	1,323

Meat, Milk and Eggs were totally absent, while up to September inclusive a gross daily average of one ounce of fresh fish per person was provided; also an average of two small bananas per person per month, and no citrus fruit at all. Green vegetables were almost all supplied by the Camp Garden.

During 1944 the Camp Garden supplied the Camp with 247,765 lbs. (approx. 124 tons) of Produce. 117 tons were green vegetables, of which the largest crop was Tulinum, 75 tons.

Average loss of weight among adults (19 years and over) during internment:-

	Av. Loss upto 15th Aug. 1944	Av. Loss since 15th Aug. 1944	Total Avg. Loss at 20th Jan. 1945
Men	27 lbs	24 lbs	51 lbs
Women	16 lbs	16 lbs	32 lbs
Total Avg.	22 1/2 lbs	20 lbs	42 1/2 lbs

ATLANTIC GULF & PACIFIC
COMPANY.

ENGINEERS, CONTRACTORS,
MANUFACTURERS.

MANILA TRADING
& SUPPLY CO.

Exclusive Dealers of

F O R D
Products.

GREETINGS and BEST WISHES
to our
LIBERATING FORCES

Thanks for everything

HAMILTON-BROWN
Quality--Apparel
Escobita Manila

KLIM

Price Jan. 20th. 1945
US\$1.25 per lb.
and worth it!

GETZ BROS. & CO.
Manila.

FRED. WILSON & CO. INC.
Manila.

Machinery & Supplies

MARSMAN & COMPANY INC.
 Industrial & Management
 Engineers
 Commercial & Manufacturing
 Enterprises
 Mining
 Appraisals

Head Office: Manila.

MARSMAN TRADING
 CORPORATION

Suppliers - Indenters
 Manufacturers'
 Representatives.

Branches
 throughout
 the Philippines

GREETINGS
 to our FORCES
 of Liberation.

CARDINAL INSURANCE COMPANY
 Manila

Fire

Marine

We follow the Flag

AMERICAN HARDWARE
 & PLUMBING CO.
 Manila

Wholesale - Retail
 Building Estimates

Radiograms

Radioletters

GLOBE WIRELESS LTD.

Radio Communication
 to and from
 America Hawaii
 and ships at sea.

Prompt Friendly Service

The total area of the Camp
 itself, including Santa Catalina and part of
 Calle Gov. Forbes, but excluding Seminary and
 other University property not available to Inter-
 nees:- 195,345 square meters (approx. 50 acres).

Total Garden Areas:- 30,126 sq. meters.
 Shanty Area "A" 17,620 " "
 " " "B" 8,605 " "
 " " "C" 17,490 " "
 " " "D" 9,769 " "

Length of each outside wall:- 465 meters.

Number of Shanties:- 683
 Number living in Shanties:- 1108

As a result of the number living in Shanties
 the space available for sleeping quarters in
 buildings ascends to 38 sq. feet per person.

A school of approximately 700 children and
 young people, from Primary to College Grades,
 operated with permission but no help from the
 Japanese and staffed by qualified teachers or by
 experts in technical fields, was conducted in
 spite of grave lack of classroom space and short-
 age of textbooks and stationery.

A similar number of persons attended special
 adult classes until prohibited early in 1944.

Sanitary Facilities available to male
 and female Internees.

	Showers	Washbasins	W.C.	Urinals
Male	38	32	47	19
Female	33	24	53	
	Number of Persons per Unit			
Male	32	64	44	108
Female	50	70	31	

Two bathtubs in entire Camp;
 one allotted to Childrens' Hospital;
 one for women's hair washing.

No water on 3rd. Floors of Buildings 50% of time.

AMERICAN CHAMBER OF COMMERCE
 INFORMATION SERVICE
 on Escolta.

REGISTER YOUR NEW ADDRESS
 as soon as you have one
 so that your friends can find you

CENSUS STATISTICS OF THE THREE CAMPS	Los			Total
	Manila Camp	Baños Camp	Baguio Camp	
	1	2	3	
Americans	2870	1589	394	4763
British, misc.	745	329	63	1137
" Australian	100	33	--	133
" Canadian	61	56	9	126
Netherlands	50	89	--	139
Polish	25	22	--	47
Norwegian	10	10	--	20
Italian	--	16	--	16
French	7	1	--	8
Spanish	2	--	--	2
Egyptian	2	--	--	2
German	1	--	--	1
Swiss	1	--	--	1
Slovak	1	--	--	1
Nicaraguan	--	1	--	1
Chinese	--	--	1	1
Mexican	--	--	1	1
Totals	5785	2146	460	6399

LIBBY'S 100 FOODS

Libby McNeill & Libby

THE NATIONAL CITY BANK
OF NEW YORK

PRICES OF COMMODITIES IN CAMP
on December 31st, 1944

Sugar, per kilo	equivalent of US\$105.00
Rice, per kilo	60.00
Corned beef, per 12oz. can	40.00
Evaporated milk, per 14oz. can	20.00
Margarine, per lb.	90.00
Vegetable lard, per lb.	90.00
Unrefined coconut oil, per quart	70.00
Smoking tobacco, per 1/4 kilo	40.00
Cigarettes, per pack of 30	18.00
Charcoal, per kilo	10.00

GENERAL MOTORS

wishes all internees

all good fortune in picking
up their lives where they
dropped them in 1942.

INTERNEE COMMITTEE

C. C. Grinnell, Chairman.
L. Earl Carroll. ALL S. L. Lloyd.

BEMEADED

INTERNEE AGENTS

Clyde A. De Witt, Chairman.
H. B. Pond. T. J. Harrington.

THREE YEARS CAN'T STOP US!

FIREFSTONE TIRE & RUBBER
CO. (P.I.) INC.

SWIFT'S PREMIUM
HAMS & BACON

Swift & Company

UNITED ARTISTS
CORPORATION.

A. SORIANO & CIA.

PLAN OF CAMP AT SANTO TOMAS, MANILA

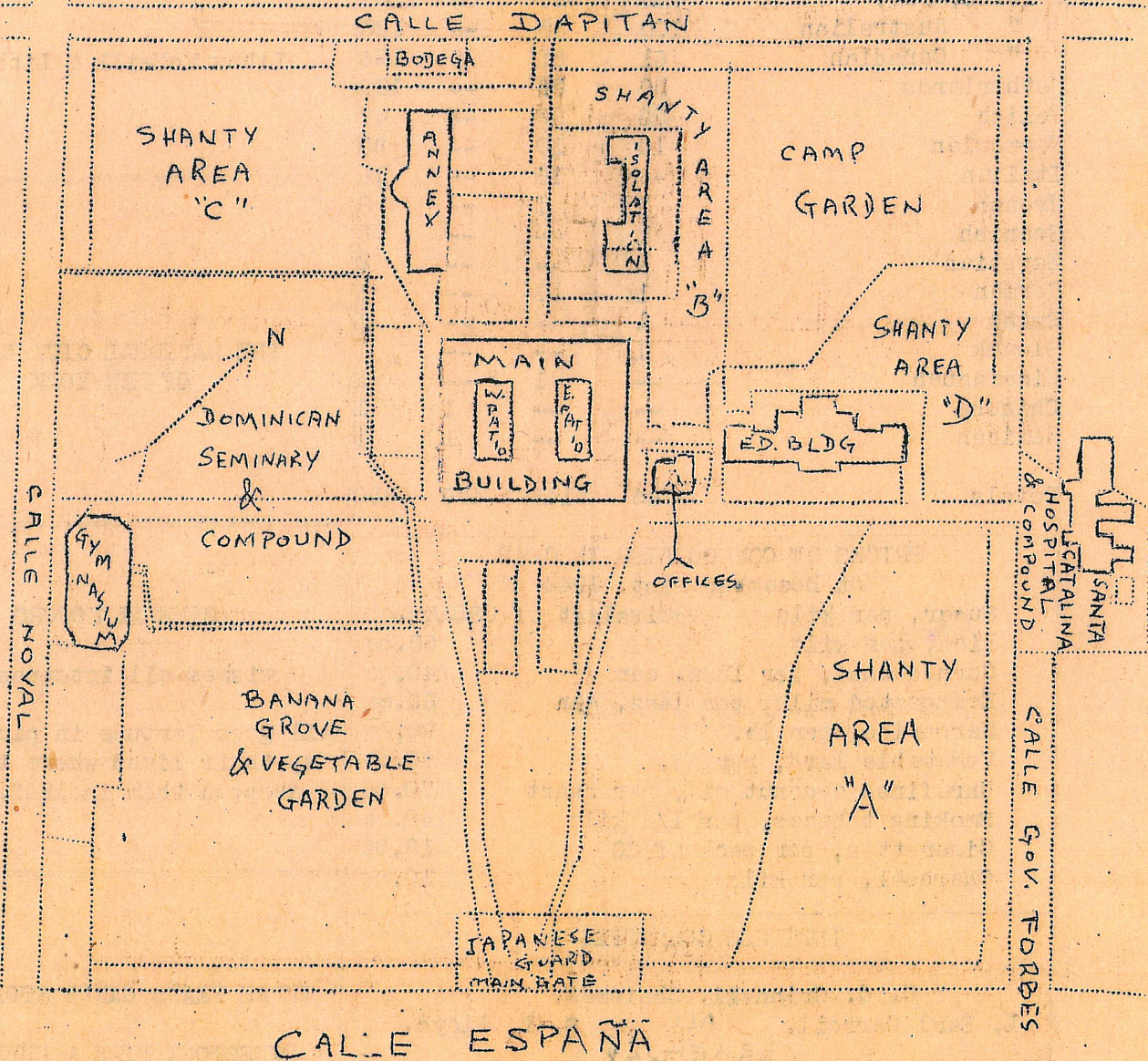

Extra copies may be obtained (subject to Military or other regulations) by mailing ₱1.00, Philippine currency, or 50 cents, U. S., to the publisher at No. 6 ULI-ULI, San Miguel, Manila, Philippines.

Published and edited by Peter C. Richards.

Reproduced on the GESTETNER Duplicator, which, without breakdown, worked every day throughout it's internment.

*Abel
#6 P. Parada San Juan
P.A.*